

**This electronic collection of documents is provided  
for the convenience of the user  
and is Not a Certified Document –**

**The documents contained herein were originally issued  
and sealed by the individuals whose names and license  
numbers appear on each page, on the dates appearing  
with their signature on that page.**

**This file or an individual page  
shall not be considered a certified document.**

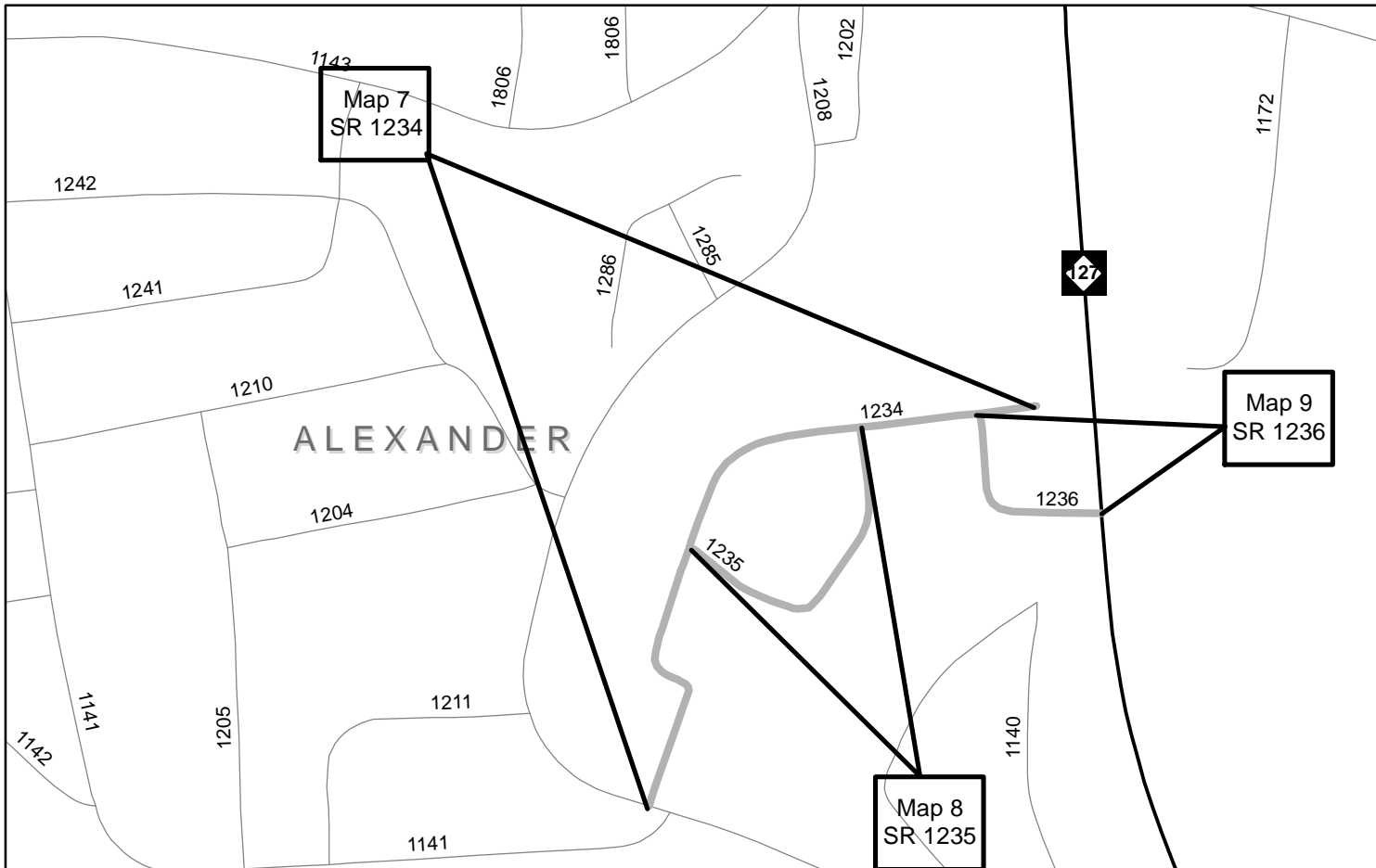

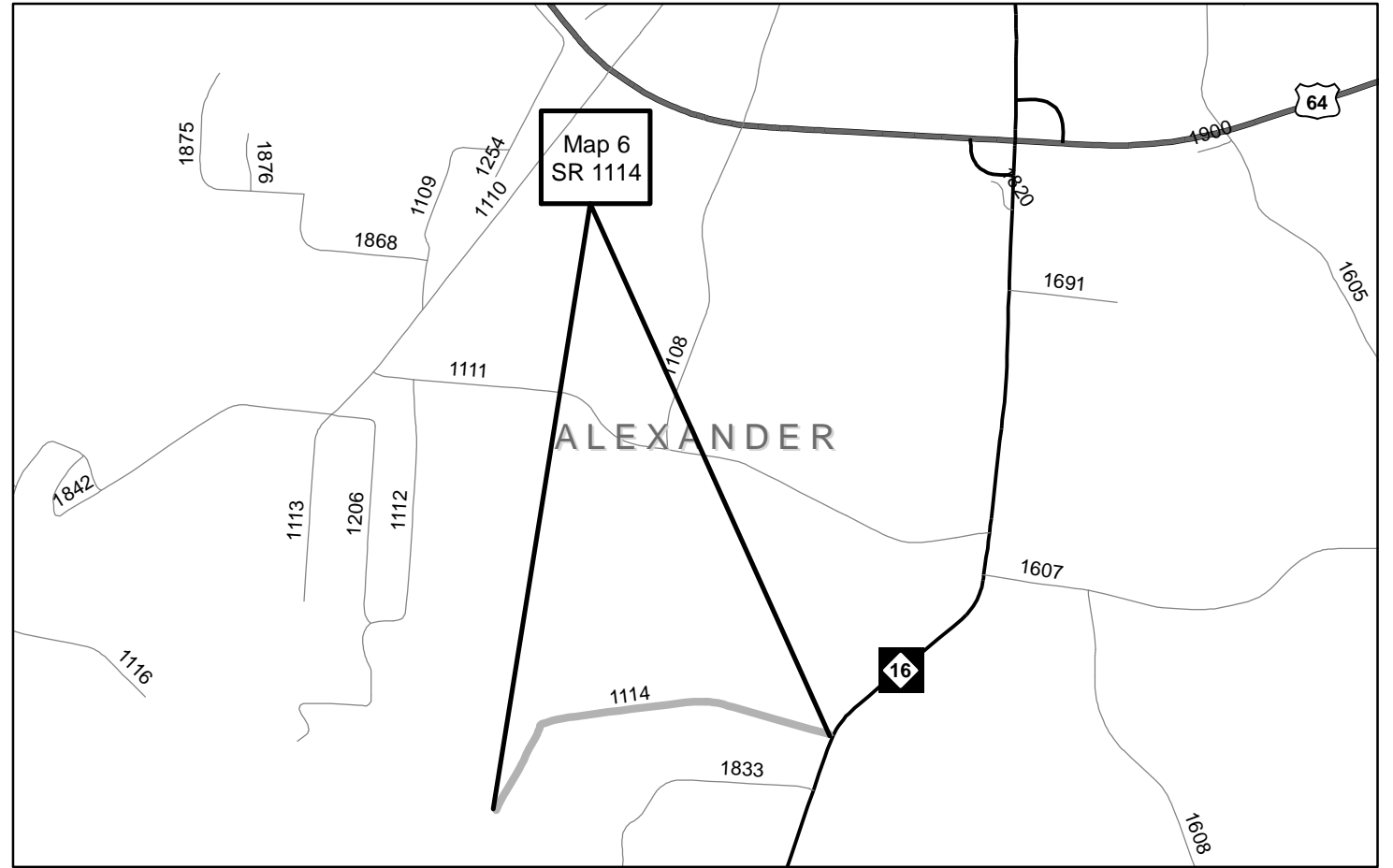
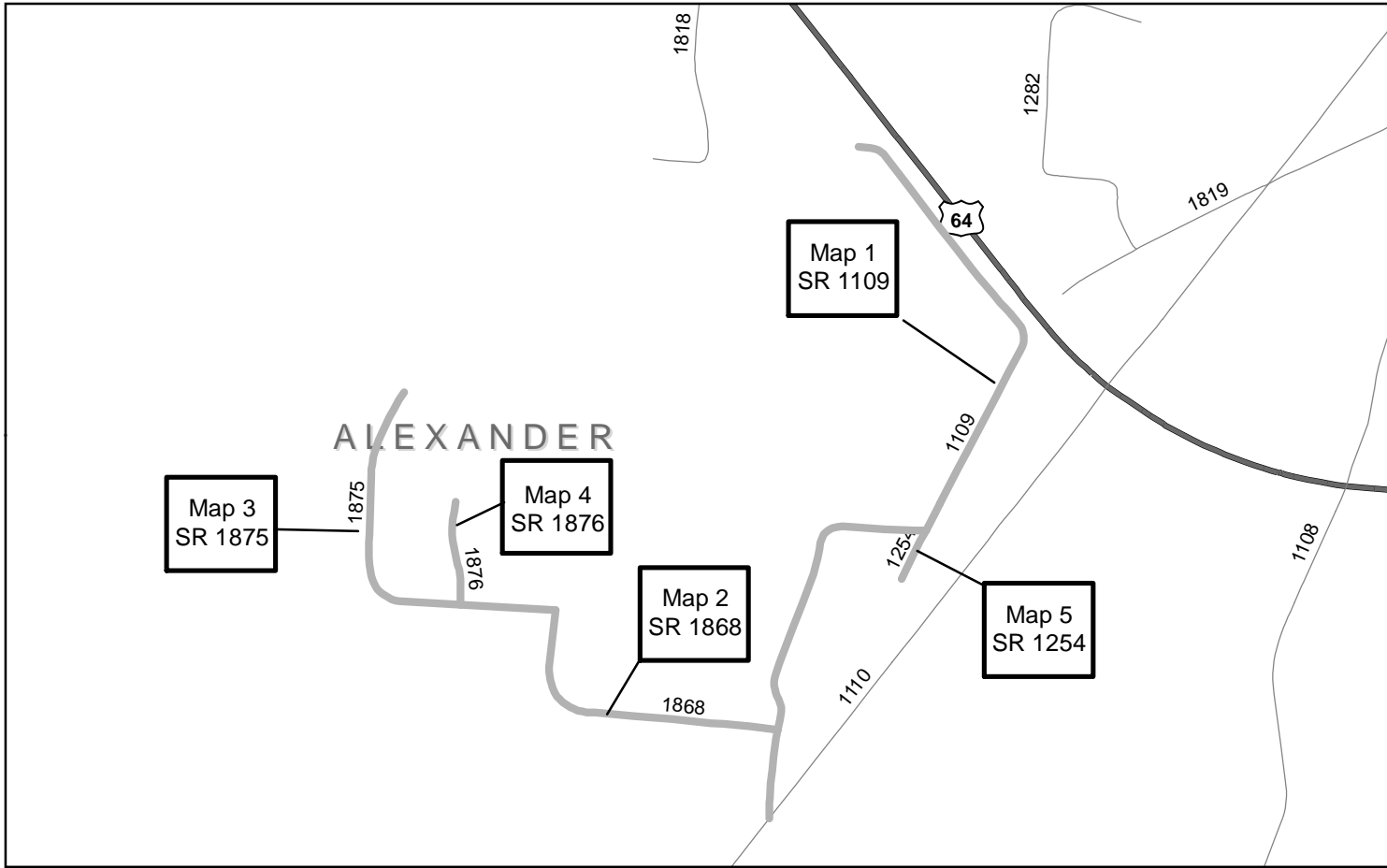
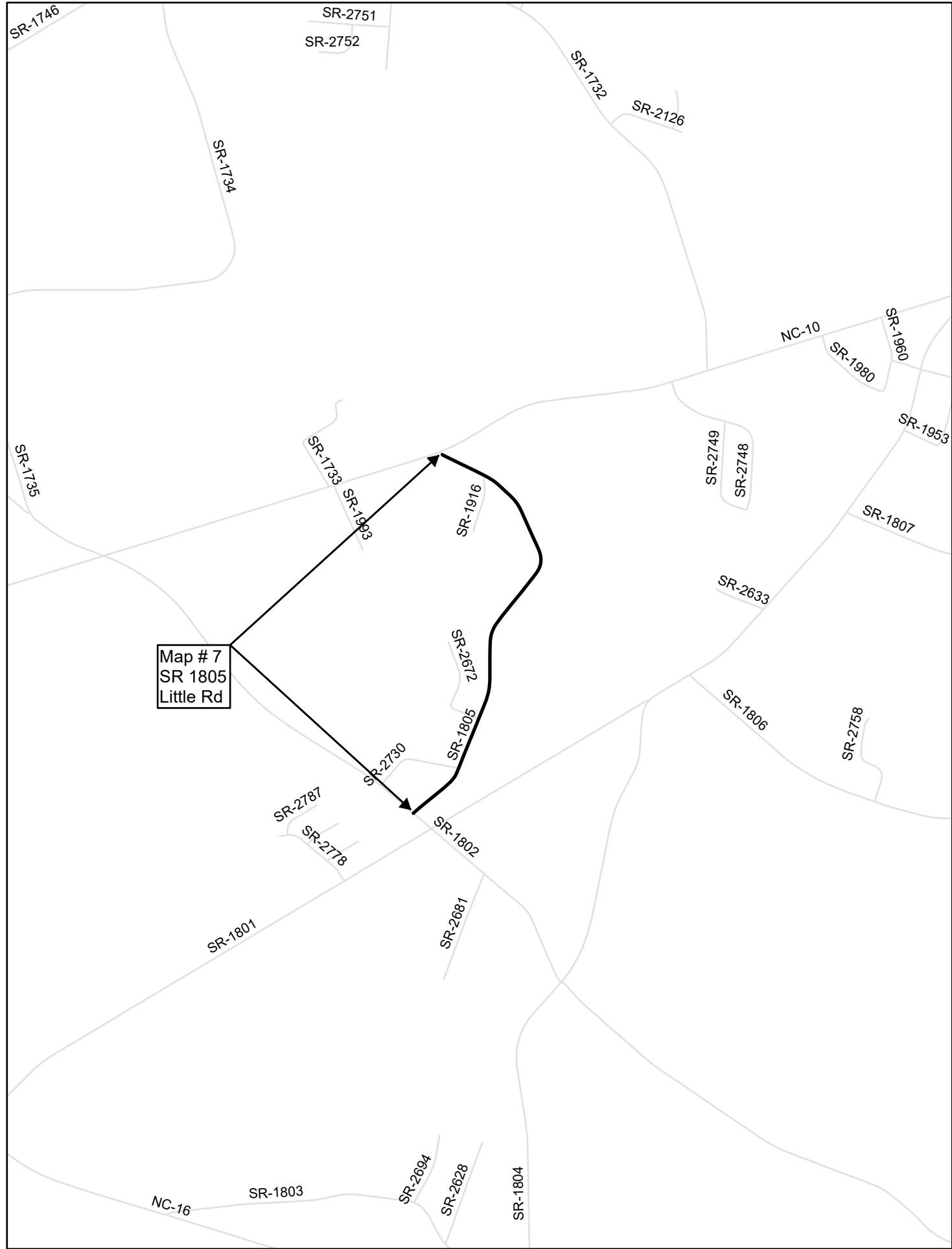
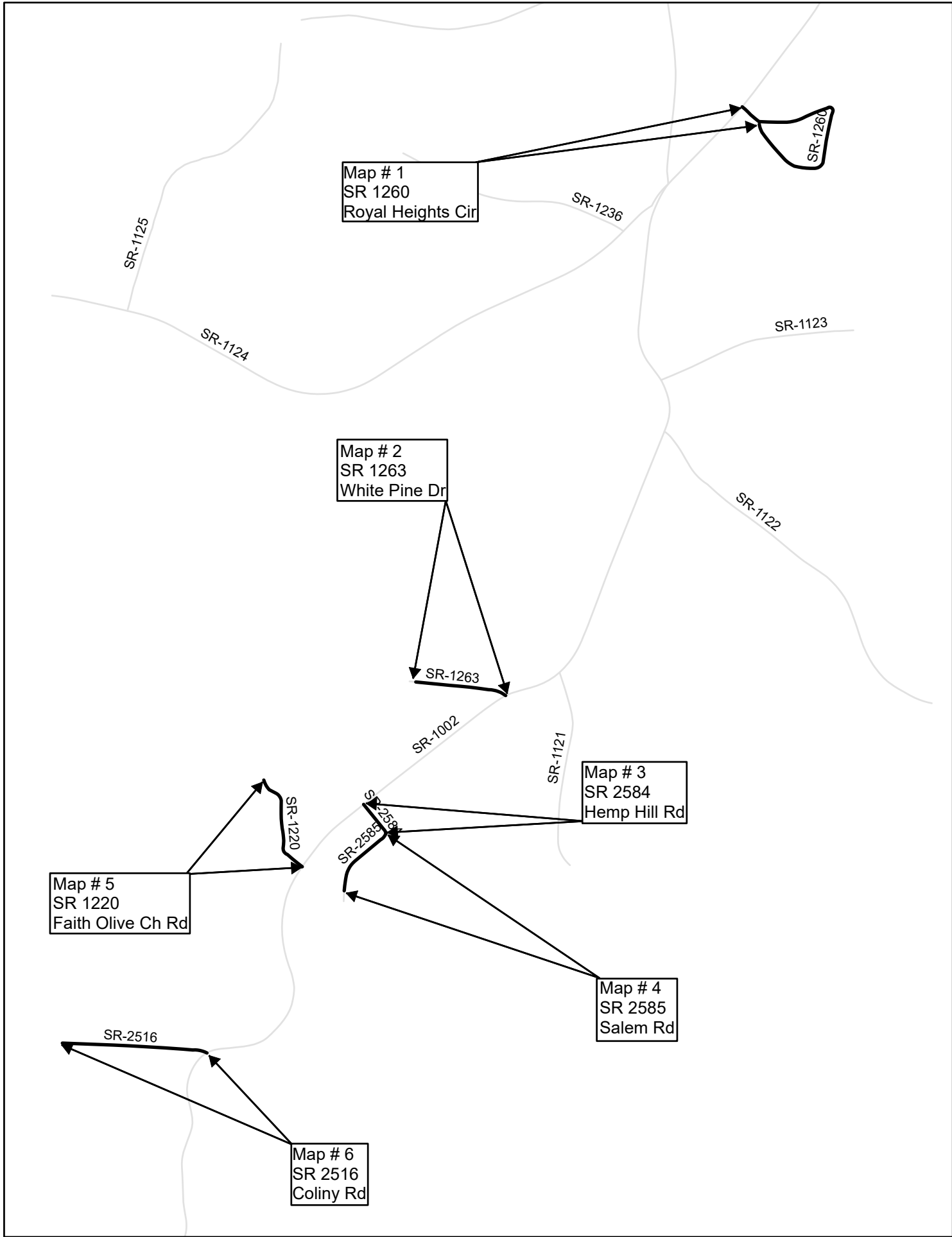

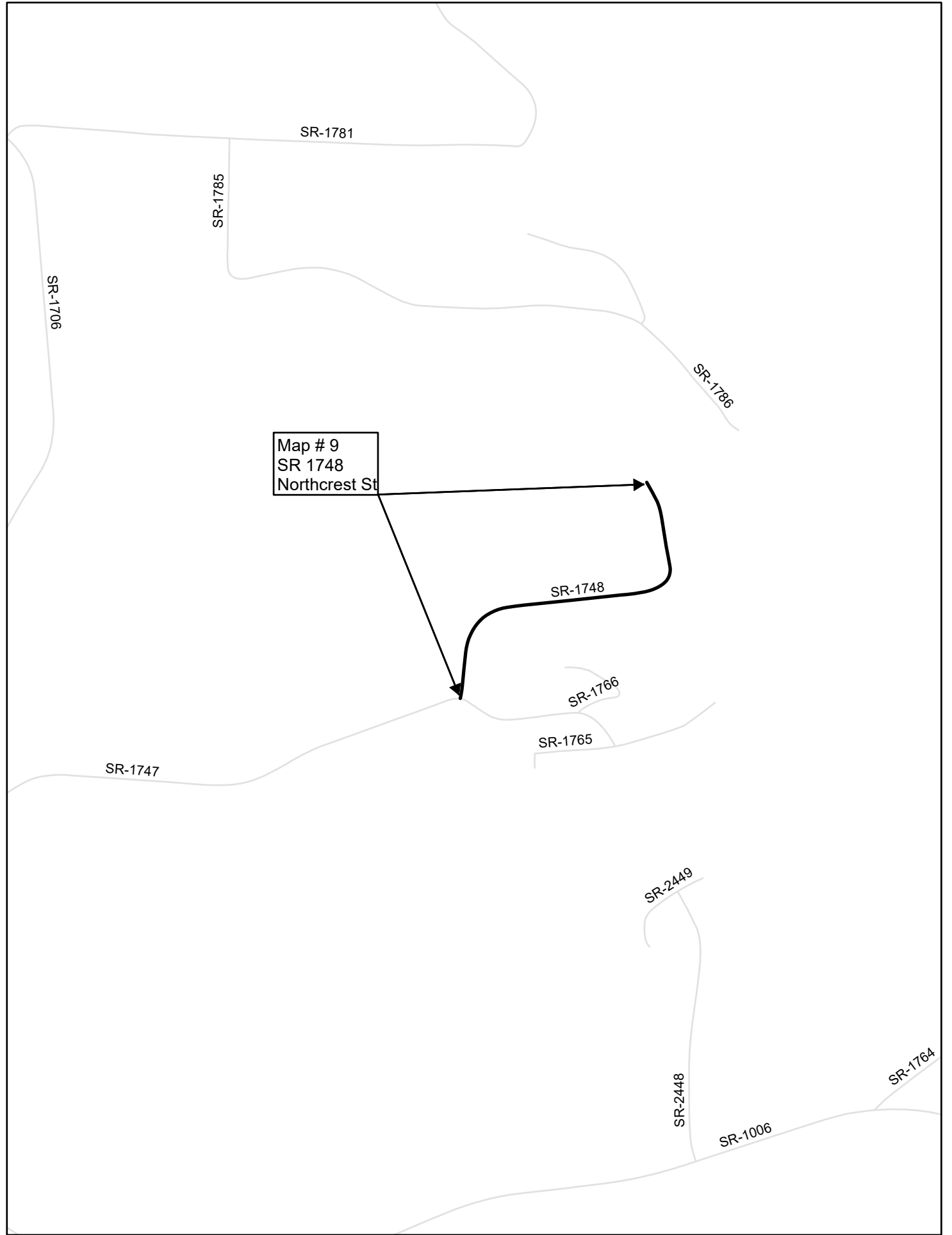
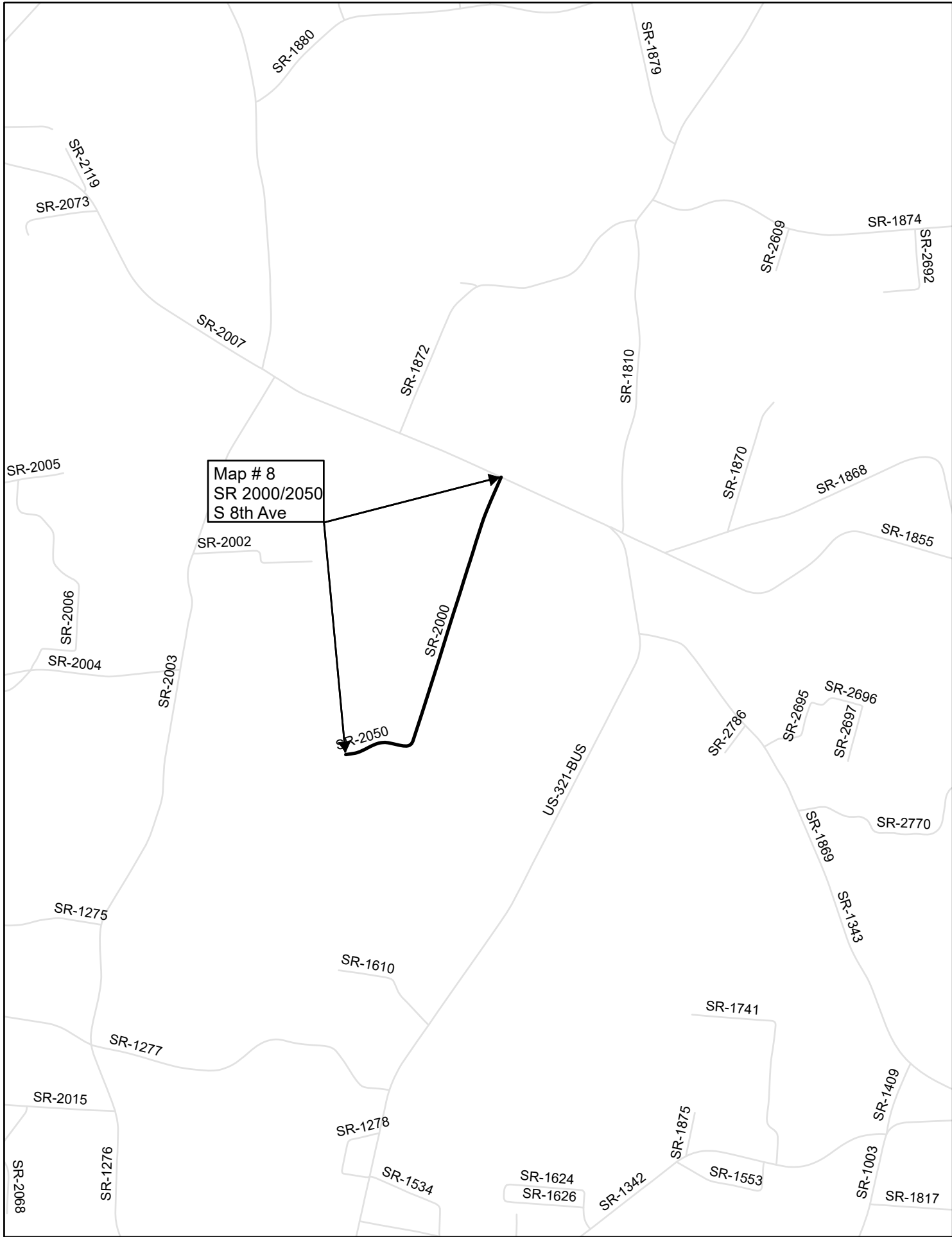

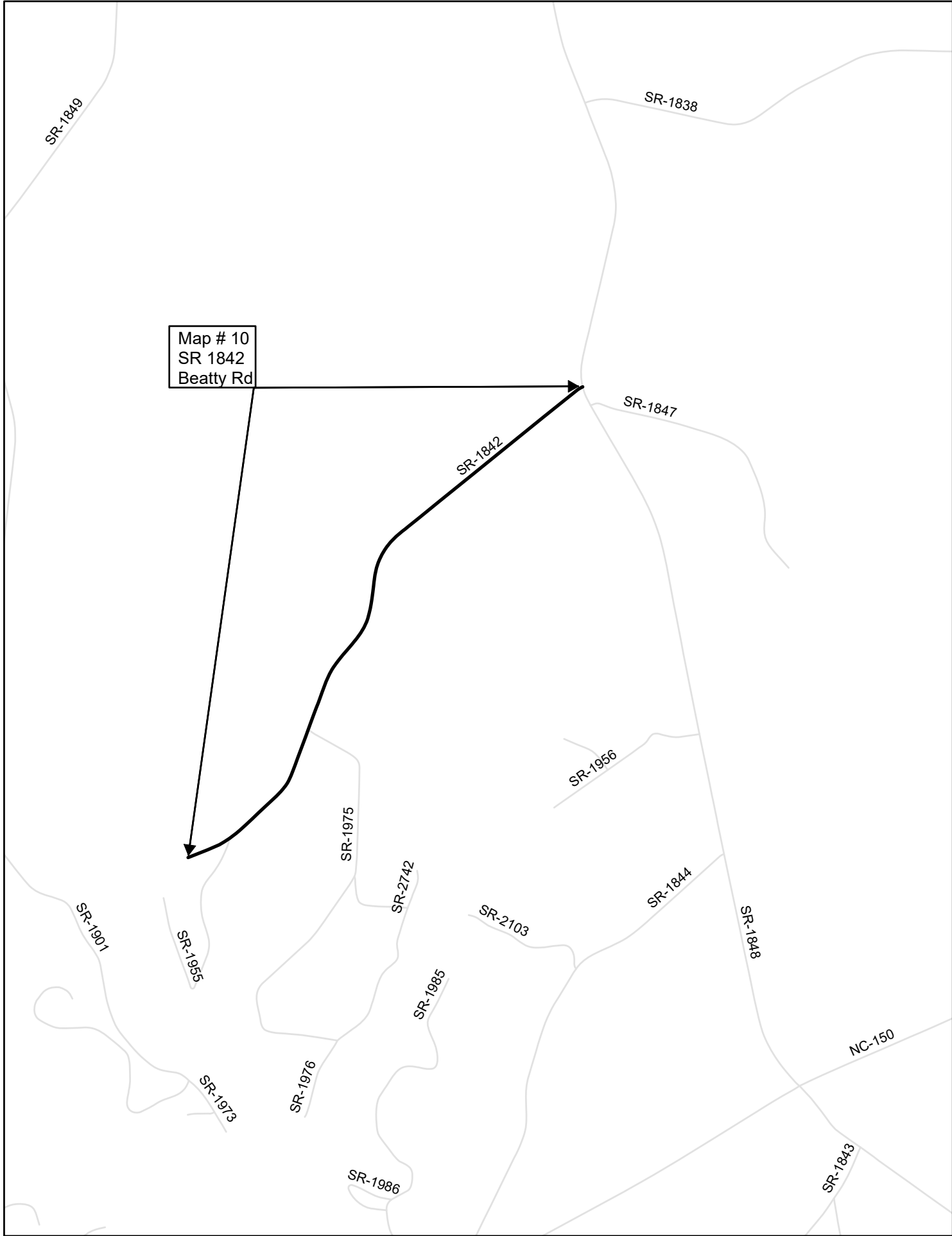

PAVEMENT SCHEDULE	
C1	PROP. APPROX. 3/4" ASPHALT CONCRETE SURFACE COURSE, TYPE S4.75A, AT AN AVERAGE RATE OF 90 LBS. PER SQ. YD.

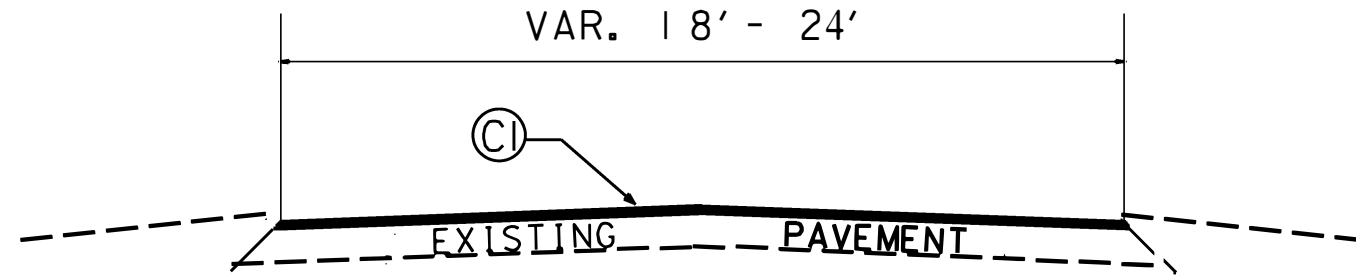

TYPICAL SECTION NO. 1

ALEXANDER CO. MAPS 1 - 9  
 CATAWBA CO. MAPS 1 - 10

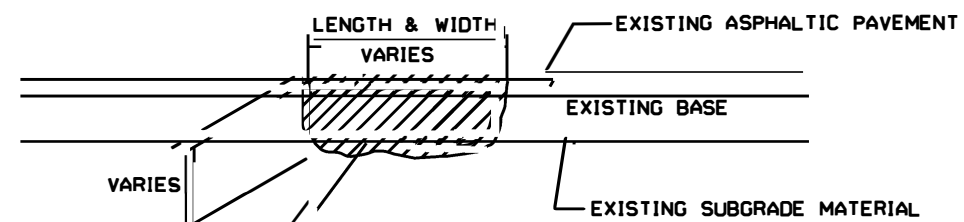

MILL EXISTING ASPHALT PAVEMENT AND REMOVE EXISTING LOOSE BASE AND/OR SUBGRADE MATERIAL AND REPLACE WITH ACBC OR ACSC AS DIRECTED BY THE ENGINEER

PARTIAL DEPTH PAVEMENT REPAIR DETAIL

PAVEMENT PRESERVATION  
 2023-2024

PROJECT NO.	SHEET NO.	TOTAL NO.
2024CPT.12.11.20022		

### SUMMARY OF QUANTITIES

PROJECT NO	COUNTY	MAP NO	ROUTE	DESCRIPTION	TYP NO	LANES	LANE TYPE	FINAL SURFACE TESTING REQUIRED	WARM MIX ASPHALT REQUIRED	LENGTH	WIDTH	1526000000-E	1575000000-E	1880000000-E		
												ASPHALT CONC SURFACE COURSE, TYPE S4.75A	ASPHALT BINDER FOR PLANT MIX	PARTIAL DEPTH PAVEMENT REPAIR		
												MI	FT	TON	TONS	TONS
2024CPT.12.11.20022	Alexander	1	SR-1109 / JENKINS MOOSE RD	FROM SR 1100 (LILEDOUN RD.) TO DEAD END	1	2	2WU	NO	NO	1.009	20	725	58	150		
2024CPT.12.11.20022	Alexander	2	SR-1868 / CORNERSTONE DR	FROM SR 1109 (JENKINS MOOSE RD.) TO SR 1875 (GRAPEVINE CIR.)	1	2	2WU	NO	NO	0.363	21	275	22	55		
2024CPT.12.11.20022	Alexander	3	SR-1875 / GRAPEVINE CIR	FROM SR 1868 (CORNERSTONE DR.) TO END OF MAINTENANCE	1	2	2WU	NO	NO	0.45	21	350	28	70		
2024CPT.12.11.20022	Alexander	4	SR-1876 / WINDSONG LN	FROM SR 1875 (GRAPEVINE CIR.) TO CUL-DE-SAC	1	2	2WU	NO	NO	0.12	21	100	8	20		
2024CPT.12.11.20022	Alexander	5	SR-1254 / NELSON JENKINS LN	FROM SR 1109 (JENKINS MOOSE RD.) TO DEAD END	1	2	2WU	NO	NO	0.063	20	60	5	10		
2024CPT.12.11.20022	Alexander	6	SR-1114 / FAIRGROUNDS RD	FROM NC 16 TO END OF PVMT	1	2	2WU	NO	NO	0.198	18	150	12	30		
2024CPT.12.11.20022	Alexander	7	SR-1234 / SKYLINE RD	FROM SR 1208 (SHILOH CHURCH RD.) TO DEAD END	1	2	2WU	NO	NO	0.439	21	350	28	70		
2024CPT.12.11.20022	Alexander	8	SR-1235 / SKYLINE ROAD EXT	FROM SR 1234 (SKYLINE RD.) TO SR 1234 (SKYLINE RD.)	1	2	2WU	NO	NO	0.2	21	165	13	30		
2024CPT.12.11.20022	Alexander	9	SR-1236 / GAZEBO RD	FROM SR 1234 (SKYLINE RD.) TO NC 127	1	2	2WU	NO	NO	0.127	19	100	8	20		
<b>TOTAL FOR PROJ NO. 2024CPT.12.11.20022</b>										<b>2.969</b>		<b>2,275</b>	<b>182</b>	<b>455</b>		
<b>GRAND TOTAL</b>										<b>2.969</b>		<b>2,275</b>	<b>182</b>	<b>455</b>		

PROJECT NO.	SHEET NO.	TOTAL NO.
2024CPT.12.11.20022		

**THERMOPLASTIC AND PAINT QUANTITIES**

PROJECT NO	COUNTY	MAP NO	ROUTE	DESCRIPTION	TYP NO	LANES	LANE TYPE	LENGTH	WIDTH	4413000000-E	4457000000-N	4810000000-E	4810000000-E	
								MI	FT	WORK ZONE ADVANCE/GENERAL WARNING SIGNING	TEMPORARY TRAFFIC CONTROL	4" WHITE PAINT	4" YELLOW PAINT	
								SF	LS	LF	LF			
2024CPT.12.11.20022	Alexander	1	SR-1109 / JENKINS MOOSE RD	FROM SR 1100 (LILEDOUN RD.) TO DEAD END	1	2		1.009	20	112			23,500	23,500
2024CPT.12.11.20022	Alexander	2	SR-1868 / CORNERSTONE DR	FROM SR 1109 (JENKINS MOOSE RD.) TO SR 1875 (GRAPEVINE CIR.)	1	2		0.363	21	41				
2024CPT.12.11.20022	Alexander	3	SR-1875 / GRAPEVINE CIR	FROM SR 1868 (CORNERSTONE DR.) TO END OF MAINTENANCE	1	2		0.45	21	50				
2024CPT.12.11.20022	Alexander	4	SR-1876 / WINDSONG LN	FROM SR 1875 (GRAPEVINE CIR.) TO CUL-DE-SAC	1	2		0.12	21	15				
2024CPT.12.11.20022	Alexander	5	SR-1254 / NELSON JENKINS LN	FROM SR 1109 (JENKINS MOOSE RD.) TO DEAD END	1	2		0.063	20	10				
2024CPT.12.11.20022	Alexander	6	SR-1114 / FAIRGROUNDS RD	FROM NC 16 TO END OF PVMT	1	2		0.198	18	25			4,600	4,600
2024CPT.12.11.20022	Alexander	7	SR-1234 / SKYLINE RD	FROM SR 1208 (SHILOH CHURCH RD.) TO DEAD END	1	2		0.439	21	50				
2024CPT.12.11.20022	Alexander	8	SR-1235 / SKYLINE ROAD EXT	FROM SR 1234 (SKYLINE RD.) TO SR 1234 (SKYLINE RD.)	1	2		0.2	21	25				
2024CPT.12.11.20022	Alexander	9	SR-1236 / GAZEBO RD	FROM SR 1234 (SKYLINE RD.) TO NC 127	1	2		0.127	19	15				
<b>TOTAL FOR PROJ NO. 2024CPT.12.11.20022</b>								<b>2.969</b>		<b>343</b>	<b>*</b>	<b>28,100</b>	<b>28,100</b>	
<b>GRAND TOTAL</b>								<b>2.969</b>		<b>343</b>	<b>*</b>	<b>28,100</b>	<b>28,100</b>	



PROJECT NO.	SHEET NO.	TOTAL NO.
2024CPT.12.11.20182		

### SUMMARY OF QUANTITIES

PROJECT NO	COUNTY	MAP NO	ROUTE	DESCRIPTION	TYP NO	LANES	LANE TYPE	FINAL SURFACE TESTING REQUIRED	WARM MIX ASPHALT REQUIRED	LENGTH	WIDTH	1526000000-E	1575000000-E	1880000000-E	2830000000-N	2845000000-N		
												ASPHALT CONC SURFACE COURSE, TYPE S4.75A	ASPHALT BINDER FOR PLANT MIX	PARTIAL DEPTH PAVEMENT REPAIR	ADJUSTMENT OF MANHOLES	ADJUSTMENT OF METER OR VALVE BOXES		
												MI	FT	TON	TONS	TONS	EA	EA
2024CPT.12.11.20182	Catawba	1	SR-1260 / ROYAL HEIGHTS CIR	FROM SR 1124 (OLD SHELBY RD) TO SR 1260 ROYAL HEIGHTS CIR	1	2	2WU	NO	NO	0.42	20	286	21	25		1		
2024CPT.12.11.20182	Catawba	2	SR-1263 / WHITE PINE DR	FROM SR 1002 (OLD SHELBY RD) TO END MAINT	1	2	2WU	NO	NO	0.16	19	103	7					
2024CPT.12.11.20182	Catawba	3	SR-2584 / HEMPHILL RD	FROM SR 1002 (OLD SHELBY RD) TO SR 2585 (SALEM RD)	1	2	2WU	NO	NO	0.07	20	48	4	20				
2024CPT.12.11.20182	Catawba	4	SR-2585 / SALEM RD	FROM SR 2584 (HEMP HILL RD) TO DEAD END	1	2	2WU	NO	NO	0.13	20	88	7	20				
2024CPT.12.11.20182	Catawba	5	SR-1220 / FAITH OLIVE CHURCH RD	FROM SR 1002 (OLD SHELBY RD) TO END MAINT	1	2	2WU	NO	NO	0.25	19	162	13	40				
2024CPT.12.11.20182	Catawba	6	SR-2516 / COLINY RD	FROM SR 1002 (OLD SHELBY RD) TO DEAD END	1	2	2WU	NO	NO	0.26	18	159	11					
2024CPT.12.11.20182	Catawba	7	SR-1805 / LITTLE RD	FROM SR 1802 (MT OLIVE CH RD) TO NC 10	1	2	2WU	NO	NO	1.04	18	637	47	40				
2024CPT.12.11.20182	Catawba	8	SR-2000, SR- 2050 / S 8TH AV	FROM US 321 BUS TO DEAD END	1	2	2WU	NO	NO	0.97	18	594	45	80	1	1		
2024CPT.12.11.20182	Catawba	9	SR-1748 / NORTHCREST ST	FROM SR 1747 (CARPENTERS COVE) TO DEAD END	1	2	2WU	NO	NO	0.45	18	276	21	40				
2024CPT.12.11.20182	Catawba	10	SR-1842 / BEATTY RD	FROM SR 1848 (SHERRILS FORD RD) TO END MAINTENANCE	1	2	2WU	NO	NO	1.57	20	1,068	77	40				
<b>TOTAL FOR PROJ NO. 2024CPT.12.11.20182</b>												<b>5.32</b>		<b>3,421</b>	<b>253</b>	<b>305</b>	<b>1</b>	<b>2</b>
<b>GRAND TOTAL</b>												<b>5.32</b>		<b>3,421</b>	<b>253</b>	<b>305</b>	<b>1</b>	<b>2</b>

PROJECT NO.	SHEET NO.	TOTAL NO.
2024CPT.12.11.20182		

### THERMOPLASTIC AND PAINT QUANTITIES

PROJECT NO	COUNTY	MAP NO	ROUTE	DESCRIPTION	TYP NO	LANES	LANE TYPE	LENGTH	WIDTH	TEMPORARY TRAFFIC CONTROL	WORK ZONE ADVANCE GENERAL WARNING	4" WHITE PAINT	4" YELLOW PAINT
								MI	FT	LS	SF	LF	LF
								4457000000-N 4413000000-E 4810000000-E 4810000000-E					
2024CPT.12.11.20182	Catawba	1	SR-1260 / ROYAL HEIGHTS CIR	FROM SR 1124 (OLD SHELBY RD) TO SR 1260 ROYAL HEIGHTS CIR	1	2	2WU	0.42	20		24		
2024CPT.12.11.20182	Catawba	2	SR-1263 / WHITE PINE DR	FROM SR 1002 (OLD SHELBY RD) TO END MAINT	1	2	2WU	0.16	19		24		
2024CPT.12.11.20182	Catawba	3	SR-2584 / HEMPHILL RD	FROM SR 1002 (OLD SHELBY RD) TO SR 2585 (SALEM RD)	1	2	2WU	0.07	20		24		
2024CPT.12.11.20182	Catawba	4	SR-2585 / SALEM RD	FROM SR 2584 (HEMP HILL RD) TO DEAD END	1	2	2WU	0.13	20				
2024CPT.12.11.20182	Catawba	5	SR-1220 / FAITH OLIVE CHURCH RD	FROM SR 1002 (OLD SHELBY RD) TO END MAINT	1	2	2WU	0.25	19		24		
2024CPT.12.11.20182	Catawba	6	SR-2516 / COLINY RD	FROM SR 1002 (OLD SHELBY RD) TO DEAD END	1	2	2WU	0.26	18		24		
2024CPT.12.11.20182	Catawba	7	SR-1805 / LITTLE RD	FROM SR 1802 (MT OLIVE CH RD) TO NC 10	1	2	2WU	1.04	18		80		
2024CPT.12.11.20182	Catawba	8	SR-2000, SR- 2050 / S 8TH AV	FROM US 321 BUS TO DEAD END	1	2	2WU	0.97	18		72	18,450	18,450
2024CPT.12.11.20182	Catawba	9	SR-1748 / NORTHCREST ST	FROM SR 1747 (CARPENTERS COVE) TO DEAD END	1	2	2WU	0.45	18		24	7,650	7,650
2024CPT.12.11.20182	Catawba	10	SR-1842 / BEATTY RD	FROM SR 1848 (SHERRILS FORD RD) TO END MAINTENANCE	1	2	2WU	1.57	20		56	32,750	32,750
<b>TOTAL FOR PROJ NO. 2024CPT.12.11.20182</b>								<b>5.32</b>		<b>*</b>	<b>352</b>	<b>58,850</b>	<b>58,850</b>
<b>GRAND TOTAL</b>								<b>5.32</b>		<b>*</b>	<b>352</b>	<b>58,850</b>	<b>58,850</b>

# SIGNING FOR RESURFACING PROJECTS

**LEGEND**  
 ┆ STATIONARY SIGN  
 ← DIRECTION OF TRAFFIC FLOW

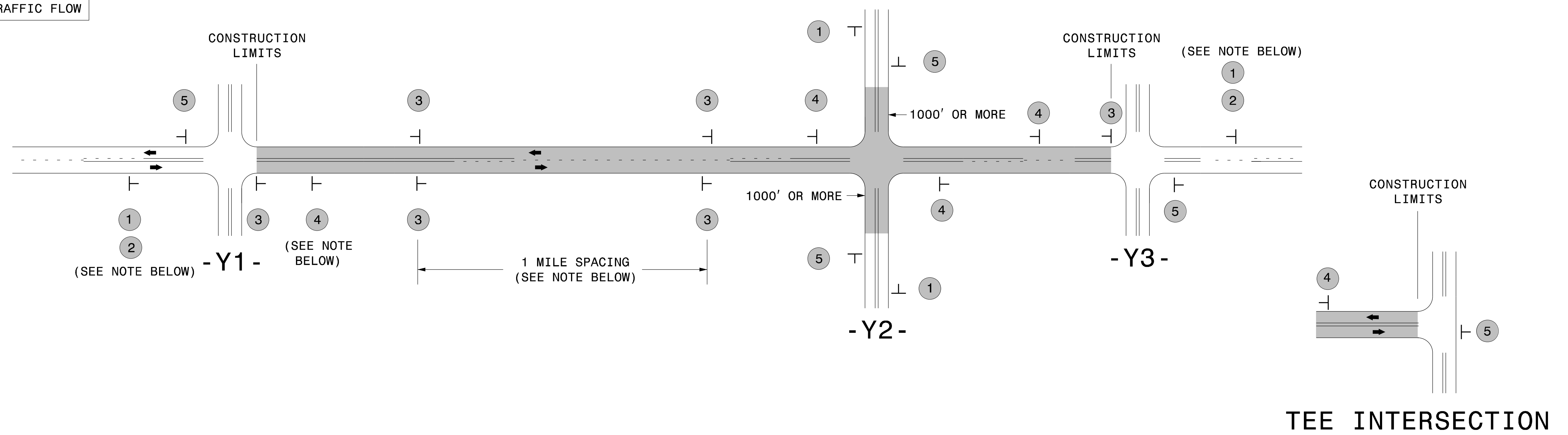

## MAINLINE (-L-) SIGNING

## -Y- LINE SIGNING

SIGNING NOTES AND PLACEMENT PER DIRECTION	1		PLACE 1000' PRIOR TO BEGINNING OF CONSTRUCTION LIMITS. ONLY USED ON -Y- LINES IF RESURFACING LIMITS EXTEND 1000' ALONG -Y- LINE.	<p>NO REQUIRED STATIONARY SIGNING FOR THE FOLLOWING -Y- LINE CONDITIONS:</p> <ol style="list-style-type: none"> <li>LESS THAN 1000' OF RESURFACING ALONG -Y- LINE</li> <li>SUBDIVISION ROADS</li> <li>DEAD END ROADS</li> </ol> <p>WHEN PAVING/CONSTRUCTION ACTIVITIES PROCEED ACROSS AN UNSIGNED -Y- LINE, PORTABLE ADVANCE WARNING SIGNS SHALL BE USED ALONG THE -Y- LINE AS SHOWN BELOW. REMOVE UPON COMPLETION OF WORK.</p> <div style="display: flex; justify-content: space-around;"> <div style="text-align: center;">             W20-1 48" X 48"            PLACED 500' IN ADVANCE OF FLAGGER.         </div> <div style="text-align: center;">             W20-7 A 48" X 48"            PLACED 250' IN ADVANCE OF FLAGGER.         </div> </div>
	2		#2 SIGN ONLY USED WHEN CONSTRUCTION LIMITS ARE 2 OR MORE MILES IN LENGTH. ROUND UP TO NEXT WHOLE NUMBER. (NO FRACTIONAL OR DECIMAL NUMBERS)	
	3		- PLACE INITIALLY AT THE CONSTRUCTION LIMITS AND SPACE 1 MILE APART THEREAFTER. - AT TEE INTERSECTIONS INSTALL INITIALLY 1/2 MILE FROM INTERSECTION AND SPACE 1 MILE APART THEREAFTER.	
	4		- THESE ARE FOR -Y- LINES THAT ARE "THROUGH" ROADWAYS. - DEAD END AND SUBDIVISION ROADS ARE NOT "THROUGH" ROADWAYS. - INSTALL 500' +/- FROM EACH -Y- LINE APPROACH AS SHOWN ABOVE. - FOR MULTIPLE -Y- LINES THAT ARE SEPARATED BY 0.25 MILES OR LESS, TREAT AS A SINGLE UNIT AND INSTALL WITHIN 500' OF EACH APPROACH. - A MAXIMUM OF 2 SIGN SETS PER MILE. DO NOT INSTALL WHEN -Y- LINES ARE WITHIN 0.5 MILES FROM "END ROAD WORK" SIGN. - FOR TEE INTERSECTIONS, INSTALL WITHIN 500' +/- OF THE INTERSECTION ALONG -L- LINE.	
	5		PLACE 500' FOLLOWING THE END OF CONSTRUCTION LIMITS OR AS SHOWN WHEN WORK ENDS AT A 3-WAY TEE INTERSECTION.	

THE ABOVE SIGNS ARE ALL THAT ARE REQUIRED FOR A CONTRACTOR TO BEGIN A RESURFACING CONTRACT. ANY ADDITIONAL SIGNS REQUESTED BY NCDOT DIVISIONS SHALL BE INSTALLED WITHIN 7 BUSINESS DAYS OF THE START OF CONTRACT WORK.

**MAPS LESS THAN 2 MILES**

FOR RESURFACING MAPS WITH CONSTRUCTION LIMITS LESS THAN 2 MILES IN LENGTH, NO STATIONARY SIGNS ARE REQUIRED. USE PORTABLE "ROAD UNDER CONSTRUCTION" OR "ROAD WORK AHEAD" SIGNS IN LIEU OF STATIONARY ADVANCE WARNINGS SIGNS.

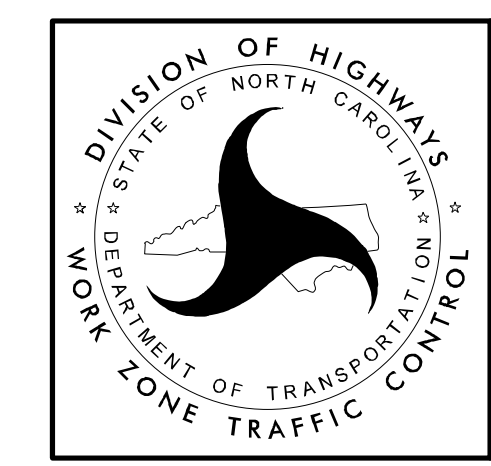

**ADVANCE WARNING SIGNS FOR RURAL AND SUBURBAN 2-LANE ROADWAY RESURFACING**

5/15/2017 S:\TUXWZTC\Resurfacing\2L2W & AST Resurfacing Details\Resurfacing\_AdvWarn\_2Ln.dgn User:kadai